

Received  
Planning Division  
05/23/2024

Exhibit 3.11

CONSTRUCTION NOTES:

- 1 CONSTRUCT AC PAVEMENT. SEE AC PAVEMENT SECTION DETAIL ON SHEET C5.0.
- 2 MATCH EXISTING CONCRETE SIDEWALK (S) OR CURB (C).
- 3 INSTALL PORTABLE CLASSROOM, TO BE PROVIDED BY THE SCHOOL DISTRICT. INSTALL FOUNDATIONS PER OREGON STRUCTURAL SPECIALTY CODE (OSSC). FOUNDATION DESIGN TO BE PROVIDED BY AN OREGON LICENSED ENGINEER AND SUBMITTED AS A DEFERRED SUBMITTAL.
- 4 PROPOSED SAWCUT LINE. REFER TO GRADING PLAN FOR ELEVATIONS.
- 5 INSTALL FIRE ACCESS SIGN PER SIGN AND POST FOOTING DETAIL ON SHEET C5.0.
- 6 EXISTING TREE TO REMAIN. PROTECT IN PLACE.
- 7 EXISTING LIGHT POLE TO REMAIN. PROTECT IN PLACE.
- 8 INSTALL PORTABLE PLATFORM STRUCTURE AND RAMPS. CONTRACTOR TO SALVAGE AND REUSE EXISTING DECKING AND PROVIDE NEW AS NECESSARY TO INSTALL NEW PORTABLE PLATFORM AND RAMPS.
- 10 PROPOSED STORM FACILITY. SEE SHEET C4.0 FOR DETAILS.
- 11 CONSTRUCT CONCRETE SIDEWALK PER DETAIL ON SHEET C5.0.
- 12 CONSTRUCT CONCRETE CURB PER DETAIL ON SHEET C5.0.
- 13 PROTECT EXISTING GATE.
- 14 CONSTRUCT 8.0' GRAVEL SECTION FOR FIRE ACCESS PER DETAIL ON SHEET C5.0.
- 15 PROPOSED COMPACTED GRAVEL UNDER PORTABLES PER SECTION ON SHEET C5.0.
- 16 PROPOSED GRAVEL DRAINAGE DITCH. REFER TO STORM PLANS FOR MORE INFORMATION.
- 17 INSTALL CONCRETE WHEEL STOP PER DETAIL ON SHEET C5.0.

SITE PLAN  
**GREENWAY PORTABLES**  
BEAVERTON, OREGON

**Harper Houf Peterson**  
**Righellis Inc.**  
ENGINEERS & PLANNERS  
LANDSCAPE ARCHITECTS & SURVEYORS  
206 SE Spokane Street, Suite 200, Portland, OR 97202  
phone: 503.221.1131 www.hhpri.com fax: 503.221.1171

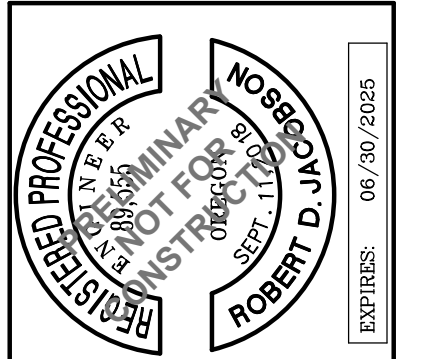

DESIGNED:	HHPR
DRAWN:	HHPR
CHECKED:	BDJ
DATE:	03/15/2024

DATE	NO.	DESCRIPTION

SHEET NO.  
**C2.0**  
JOB NO.  
BSD-122

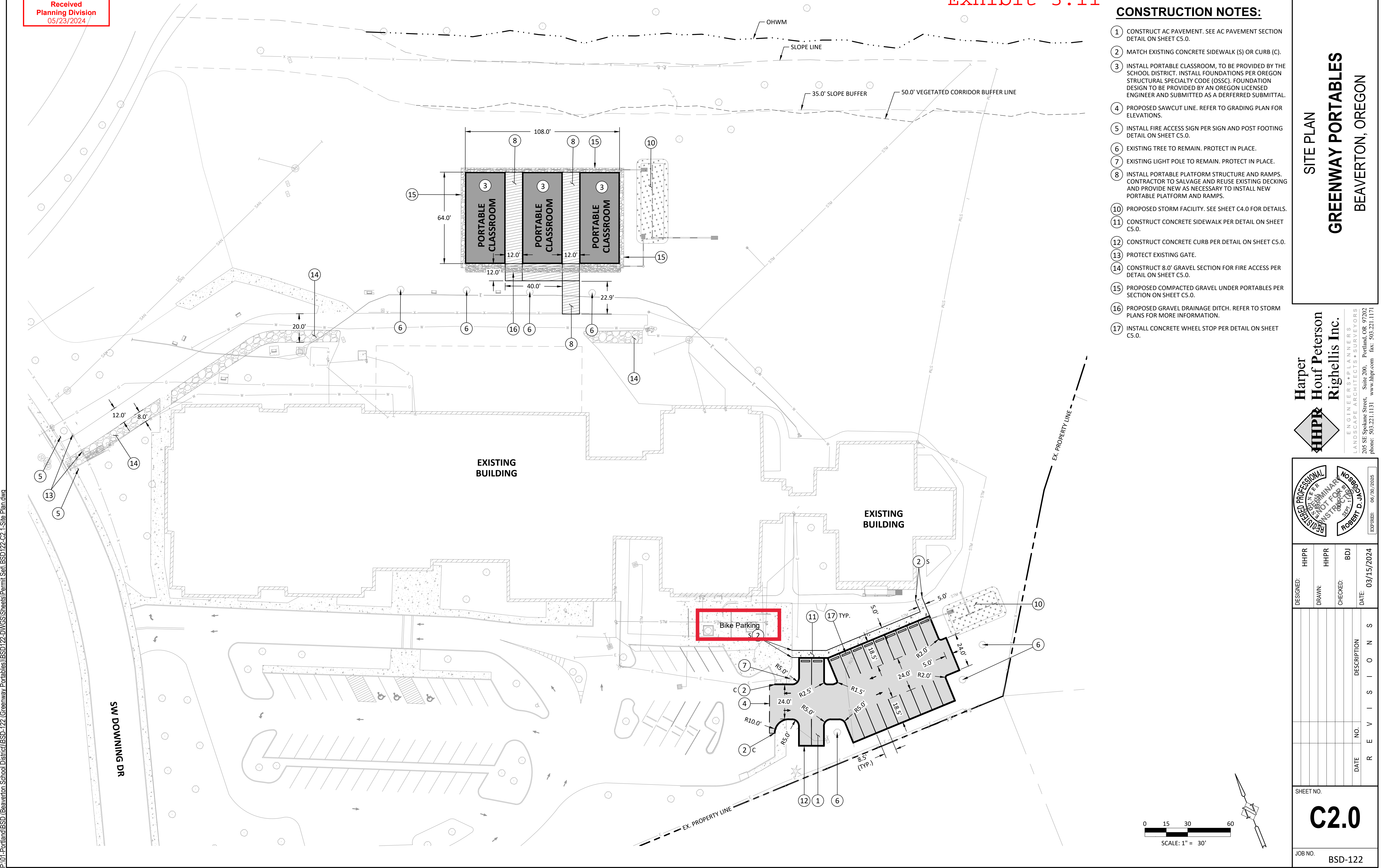

P:\01-Portland\BSD -Beaverton School District\BSD-122-Greenway Portables\Portables\BSD122-DWGS\Sheets\Permit Set\BSD122-C2-1-Site Plan.dwg



